

TRANSYLVANIA COUNTY DEPARTMENT OF PUBLIC HEALTH
Improvement Permit

A building permit cannot be issued with only an Improvement Permit

ISSUED TO: Scott, Robert and Ruth PROPERTY LOCATION: TBD Toxaway Court

New [X] Repair [] Expansion []
Type of Structure: Proposed 4 BR House
Proposed Wastewater System Type: Type IIIg - 25% reduction
Projected Daily Flow: 480 GPD
Number of bedrooms: 4 Max. No. of Occupants: 8

Site Improvements required prior to Construction Authorization Issuance:
Accurate, detailed site plan provided. House site has been staked,
fee has been paid.

Pump Required: [] Yes [] No [X] May be required based upon final location and elevations of facilities
Pump systems with an effluent pump must be designed by a Professional Engineer (P.E.) and plans submitted to the Environmental Health Section for approval.
Type of Water Supply: New SFR well Improvement Permit Expiration Date: 3/22/2027

Permit conditions:

Authorized State Agent: James A Bayer, REHS Date: 3/22/2022 See Attached Permit Diagram

The issuance of this permit by the Transylvania County Environmental Health Section in no way guarantees the issuance of other permits. The permit holder is responsible for checking with appropriate governing bodies in meeting their requirements. This permit is subject to revocation if the site plan, plat, or the intended use changes. The Improvement Permit shall not be affected by a change in ownership of the site. This permit is subject to compliance with the provisions of the Laws and Rules for Sewage Treatment and Disposal and to conditions of this permit.

SELF-INSTALLATION NOT PERMITTED - MUST USE CERTIFIED INSTALLER
Construction Authorization

(Required for Building Permit)

The construction and installation requirements of Rules .1950, .1952, .1954, .1955, .1956, .1957, .1958, and .1959 are incorporated by reference into this permit and shall be met. Systems shall be installed in accordance with the attached system layout.

ISSUED TO: Same Facility Type: Proposed 4 BR House

Basement? [X] Yes [] No Basement Plumbing Fixtures? [X] Yes [] No
Type of Wastewater System** Type IIIg - 25% reduction (Initial) Wastewater Flow: 480 GPD
(See note below, if applicable []) Same (Repair) LTAR: 0.45 GPD/ft2

Installation Requirements/Conditions

Septic Tank Size: 1,000 gallons, minimum Total Trench Length: 280 feet Trench Spacing: 9 Feet on Center
Pump Tank Size _____ gallons, minimum Trench Width: 3 feet Distribution Method: Serial - PVC only

Trenches shall be installed on contour at a maximum trench depth of: 18 inches. There shall be a minimum of 6" of soil cover over the installed drainfield material and the bottom of the trench shall not be greater than 36" from the surface of the ground at final grade.

(Trench bottoms shall be level to +/- 1/4" in all directions)

>50' SFR
Min. distance between system and nearest: Well XXXX ft. Water Line 10 ft Foundation 5/15 ft Property Line 10 ft Vertical Cut 15 ft

Permit Conditions: Install system below cluster cucumber magnolia tree as shown on diagram. Keep line lengths at 70' due to shallow soil conditions on either side of approved area. Contact TCDPH with any questions.

**If applicable:

Permit conditions, system type specified is different from the type specified on the application. I accept the specifications of this permit.

Owner/Legal Representative Signature: [Signature] Date: 3/25/2022

This Construction Authorization is subject to revocation if the site plan, plat, or the intended use changes. The Construction Authorization shall not be transferred when there is a change in ownership of the site. This Construction Authorization is subject to compliance with the provisions of the Laws and Rules for Sewage Treatment and Disposal and to the conditions of this permit. I agree to have the on-site wastewater system installed by an authorized installer in accordance with the Improvement Permit, Construction Authorization, permit diagram and any conditions specified therein.

Authorized State Agent: James A Bayer, REHS Date of Issuance: 3/22/2022

See Attached Permit Diagram

Construction Authorization Expiration Date: 3/22/2027

TRANSLYVANIA CO. ENVIRONMENTAL HEALTH SEPTIC/WEL PERMIT DIAGRAM

FILE NAME Lake Toxaway Estates
TM Phase I, Lot 24R
Scott, Robert and Ruth
TBD Toxaway Court

PERMIT NO. 22-063

PIN 8512-46-3809-000

SCALE 1" = 40'
(approx.) Date 3/21/2022

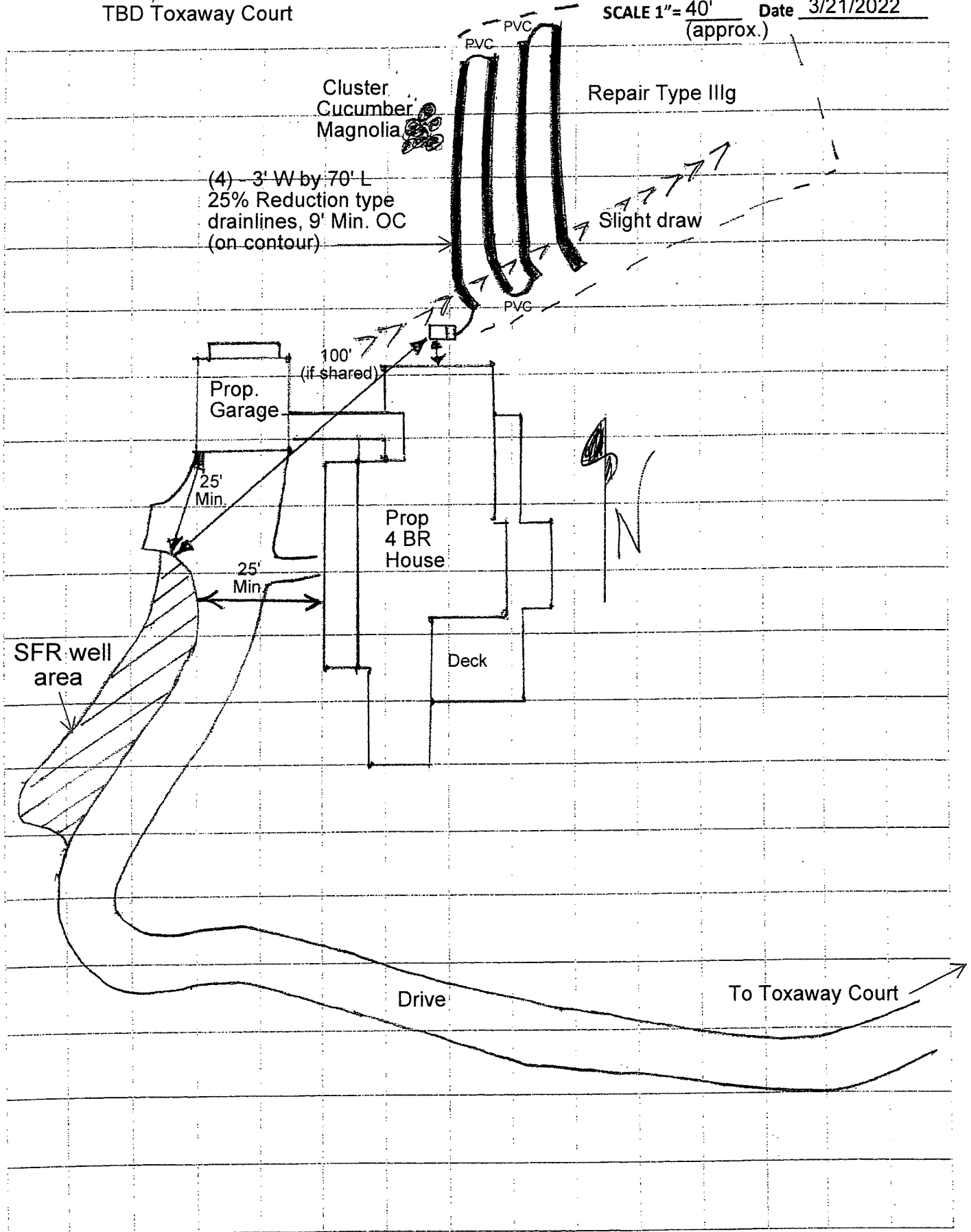

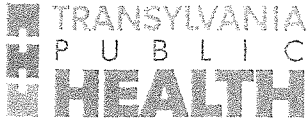

TRANSYLVANIA PUBLIC HEALTH
WELL PERMIT/WELL REPAIR PERMIT

106 E Morgan St. Suite 105
Brevard, NC 28712
828-884-3139

WP 22-034 Permit No. 8512-46-3809-000 PIN Scott, Robert and Ruth Issued To

Associated Permits: Septic # 22-063 Address/Location TBD Toxaway Court

Scale 1" = 40' (Approx.)

Comments: SFR WELL - 50' MINIMUM SEPARATION REQUIRED BETWEEN WELL AND ANY PART OF ANY SEPTIC TANK SYSTEM.
25' MINIMUM SEPARATION REQUIRED BETWEEN WELL AND ANY PART OF ANY BUILDING FOUNDATION, DECK, PORCH, GARAGE, CARPORT, ETC.
SEE WELL PERMIT DIAGRAM FOR ALLOWABLE WELL LOCATION(S)
CONTACT TCDPH WITH ANY QUESTIONS!

Permit valid for 5 years provided site conditions do not change. The well (well area) located by the Health Department is to provide protection from known possible sources of contamination. No quantity or quality of water is guaranteed at any site by the Health Department.

Issued by: James A Bayer, REHS
Issued to: [Signature]

Date: 3/22/2022
Date: 3/25/22

Permit Expires: 3/22/2027

TRANSLYVANIA CO. ENVIRONMENTAL HEALTH ~~XXXX~~/WELL PERMIT DIAGRAM

FILE NAME Lake Toxaway Estates
TM Phase I, Lot 24R
Scott, Robert and Ruth
TBD Toxaway Court

Well PERMIT NO. WP22-034 PIN 8512-46-3809-000

SCALE 1" = 40' (approx.) Date 3/21/2022

